



UG COURSES

**Bachelor of Art
Bachelor of Commerce
Bachelor of Science**

PG COURSES

**MA English
MA Hindi
MA History
MA Political Science**



PROSPECTUS 2025-26

GOVERNMENT COLLEGE SHILLAI

DISTRICT-SIRMOUR H.P.-173027

PHONE NO.-01704-292506

E-MAIL- gcshillaihp@gmail.com

Online admission link :- <https://gcshillai.highthaleducation.com>

Website: <https://gcshillai.in>

PROSPECTUS FEE:- ₹50/-



From The Principal's Desk.....

Greetings to all

I am very delighted to present the prospectus for the session 2025-26 on the behalf of Govt. College Shillai. Our endeavors at the College is to provide the platform where our students can take up the opportunities and challenges to do the things which they are capable of and to enhance their potential on all fronts. Since the inception of this institution, it has grown exceptionally and exponentially with its dedicated and vibrant staff, well maintained accommodation and extraordinary campus. The young and dynamic staff of this institution is always working for the wellbeing of the students and of this institution. With strong academic schedule, our motto is to provide a better environment with extra-curricular and recreational activities for the students. **“The best way to get started is to quit talking and begin doing”**, with this quote of Walt Disney, I would like to welcome all the doers, aspirants and beginners in this institution. We would certainly do our best for your all-round development.

Best Wishes
Dr. J.R. Kashyap
Principal

OUR INSTITUTION

Govt. College Shillai, one of the premier institutions of Himachal Pradesh, having the motto ‘Medhavi Mahiyate’, was established on 5th September, 2005 to cater to the educational needs of the students from Shillai region of district Sirmour. However, the College became operational in 2006. The College is situated on a hillock at Shillai from where an enthralling view of snow capped mountains and majestically flowing river Tons creating natural border with neighboring state Uttarakhand can be cherished. Crisp clean and fresh mountain air, blue sky blazing red and orange at sunrise and sunset all conspire to create this place a slice of heaven on earth. Shillai town, located on National Highway No 707, at an altitude of 1800 meters above the sea level, has gained name and fame worldwide for its quality ginger cultivation and culturally rich festivals like Bishu, Haryality and Budhi Diwali. The college is spread over an area of 51.02 bighas. It has a beautiful building with magnificent design along with a sprawling campus. This college is enriched with infrastructures of all sorts: Spacious Lecture Theatres, Laboratories with Latest Equipments, Smart Class Rooms, Computer Lab, Reading Room, Sports Room, Girls common Room, Canteen and a well Equipped Library with about 4500 books on different subjects and subscription to the various newspaper and monthly magazines. The fire extinguishers along with purifying water plant have been installed in the college campus. This College is affiliated to Himachal Pradesh University, Shimla. It offers Undergraduate Programmes in Humanities, Commerce, Science and Post Graduate Programmes in the subject of Hindi, English, Political Science and History. During the session 2024-25, 522 students got enrolled in this college with the majority of girl students. In the current session, the strength of the students is likely to go up. The college has a two units of NSS and one unit of Rover and Rangers, Red ribbon Club, Women Cell that inculcate social and Moral values in students including leadership qualities, sense of responsibility and dignity of labour to lay grace on their overall personality. The college publishes its magazine “Chandrika” annually which provides a perfect platform for the students with a fair for writing to give vent to their thoughts and seminal ideas. The geniuses among many talented faculty members of the college, with earnest endeavor, are committed to guide academic marches efficiently and make students full of ethical and moral values, self-confident, highly self-disciplined and self-reliant. The college is tirelessly working to promote higher education with conducive environment for quality education. With the patronage of the state government, this institution is all set to become an excellent center of education to the students from rural areas.

THE MISSION

The Higher education being at the apex of the entire educational structure influences all levels of education and thus affects the future of the nation. Our mission, as an institute of higher education, would be to inculcate among students: universal values, curiosity to acquire knowledge, habits of observation and enquiry, strong belief in their own strengths, patience and ability to work hard.

THE VISION

The entire team of professionals at this college is driven by the vision to help the students seek wisdom and follow the path of righteousness with the motive to preserve the values of democracy, justice and liberty, equality and fraternity, sense of duty and patriotism to make the nation great and strong. True education is training of both the head and the heart. Knowledge without wisdom is meaningless. Therefore, educating the mind without morals does not serve the actual purpose of education. Education means: Cultivating inner strength, learning self discipline and eagerness to learn. Educated persons are those who choose wisely and consciously under all circumstances. They choose wisdom over foolishness, good over bad and virtue over vice. The illusion of knowledge which leads to ignorance is not education. We intend to provide the society with competent men and women, who as cultivated individuals are fit to serve the society and the nation.

AIM

Our aim is to help the students develop their potential by providing right kind of leadership. To develop and integrate the intellectual, physical, aesthetic, ethical and spiritual powers of the students to make them highly humane, cultured and integrated. A fine blend of resources like excellent teaching techniques, enriching cultural, sports and co-curricular activities are designed for personal growth and development of leadership qualities and team spirit to achieve this purpose. The focus is on development of 5 C's to be successful in life: Character, commitment, Conviction, Courtesy and Courage. Education is a liberating force. It liberates us from bondage, ignorance, backwardness and vices of lower human nature. The college aims to provide the best atmosphere for learning without any discrimination, prejudice or bias against any section of the society thereby realizing the bigger aim of striving to promote equality and social justice and to reduce social and cultural differences.

ADMISSION/VACATION/EXAMINATION SCHEDULE 2025-26

Particulars	Period	Days
Submission of Admission Form	01 to 19 June, 2025	19 days
Pre-admission Counseling	13 to 19 June, 2025	7 days
Display of 1 st Merit List (UG 1 st Year)	20 June up to 5:00 PM	
Fee to be Deposited	21 to 23 June	03 days
Display of 2 nd Merit List	24 June up to 03:00 PM	
Fee to be Deposited	25 to 27 June	03 days
Orientation of 1 st Year Students	28 to 30 June	03 days
Admission of other UG classes on Roll On Basis	01 to 19 June, 2025	19 days
Fee to be Deposited	13 to 23 June, 2025	12 days
Post admission Counseling, online submission of scholarship forms and students feedback	24 to 30 June	07 days
Regular Teaching	1 st July to 15 th March of next year excluding vacation period	
	Total Teaching Days	>180 days
Annual Practical Examination/ Remedial/need based classes/self study by students	16 to 25 March, 2026	
Theory Examination	20 March to 10 May, 2026	
Evaluation of Answer Scripts	07 April to 17 May, 2026	
Results of all UG classes	up to 30 June, 2026	
Result of Re-evaluation	Up to 20 August	
Supplementary Examinations	September, 2025	
Result of Supplementary Examination	October, 2025	
Festival Break	2 days before and 2 days after Diwali	5 days
Winter Vacation	1 st January to 4 th February	35 days
Summer Vacation	19 th May to 12 th June	25 days
	Total Vacation Period	65 days

Necessary Steps for online admission (For new comers only) :

- i) Login to the College admission portal gcshillai.highthaleducation.com
Click on online admission and register yourself.
- ii) Login with your username and password.
- iii) Fill the admission form and upload the required documents.

iv) Submit the application and pay the prospectus fee.

v) Check the merit list online and also can be seen offline on the notice board of the college.

vi) Once the counseling is done, pay the fee online using your username and password.

Note:- 1. It is mandatory for a student to appear in person before the admission committee on the day of admission/counseling. The student must carry all original documents for verification. The dates of verification are mentioned above in the admission schedule.

2. The Creation of ABC ID is compulsory. Do not submit your admission forms until the process of the creation of ABC IDs (Academic Bank Credit) is completed.

The Faculty
Principal: Dr. J.R. Kashyap

Dean Students Welfare & Co-ordinator IQAC Mr. Ajay Singh Assistant Professor	Dean of Studies, RUSA Co-ordinator& NEP Coordinator Mr. Narender Sharma Assistant Professor
Bursar & Nodal Officer of AISHE and Academic Bank of Credits Dr. Anuj Sharma Assistant Professor	Sports Coordinator Mr. Anil Kumar Assistant Professor
Secretary of Staff Council Mr. Kamlesh Kumar Assistant Professor	PTA Secretary Mr. A.R. Thakur Assistant Professor

Faculty of Arts

Economics 1. Mr. Anil Kumar Assistant Professor	English 1. Ms. Vidya Verma Asstt. Professor 2. Mr. R.L. Thakur Asstt. Professor 3. Vacant
Geography 1. Mr. Kamlesh Kumar Asstt. Professor	Hindi 1. Mr. A.R.Thakur Asstt. Professor. 2. Ms. Reena Sharma Asstt. Professor
History 1. Mr. Ravinder Sharma Asstt. Professor 2. Mr. Yashpal Sharma Asstt. Professor	Music 1. Ms. Reena Devi Asstt. Professor (V)
Political Science 1. Mr. Ajay Singh Asstt. Professor 2. Mr. Narender Sharma Asst. Professor	Public Administration 1. Vacant
Sociology 1. Vacant	

Faculty of Science

Botany 1. Ms. Sujata Khamn Asstt. Professor	Chemistry 1. Ms. Ranjana Chauhan Asst. Professor
Mathematics 1. Dr. Anuj Sharma Asstt. Professor	Physics 1. Dr. Sansar Chand Asstt. Professor
Zoology 1. Ms. Reeba Thakur Asstt. Professor	

Faculty of Commerce

1. Ms. Maneesha Singh Asst. Professor	
---------------------------------------	--

Library Staff

1. Librarian Vacant 2. Mr. Devinder Singh Asstt. Librarian	
---	--

Office Staff

1. Mr. Kamraj Chauhan Supdt.Gd-I 2. Mr. Kalyan Singh Sr. Assistant 3. Mr. Rajender Singh J O A (IT)	Laboratory Staff 1. Mr. Surat Singh Senior Lect.Asstt. 2. Mr. Rajender Sing Lab Attendant 3. Mr. Pradeep Kumar Lab Attendant
Support Staff of Office 1. Mr. Hukmi RamPeon 2. Mr. Khajan Singh Peon	3. Mr. Chamel Singh Peon

TEACHING FACULTY



Sh. Ajay Singh
Assistant Professor
Political Science



Sh. Narender Sharma
Assistant Professor
Political Science



Dr. Anuj Sharma
Assistant Professor
Mathematics



Mrs. Vidya Devi
Assistant Professor
English



Sh. Kamlesh Kumar
Assistant Professor
Geography



Sh. Ravinder Kumar
Assistant Professor
History



Sh. Atma Ram
Assistant Professor
Hindi



Mrs. Reena Devi
Assistant Professor
Hindi



Mrs. Ranjna Chauhan
Assistant Professor
Chemistry



Sh. Anil Kumar
Assistant Professor
Economics



Sh. Yashpal Sharma
Assistant Professor
History



Ms. Reena Devi
Assistant Professor
Music (Vocal)



Sh. Ram Lal
Assistant Professor
English



Dr. Sansar Chand
Assistant Professor
Physics



Ms. Sujata Khamn
Assistant Professor
Botany



Ms. Reeba
Assistant Professor
Zoology



Ms. Maneesha Singh
Assistant Professor
Commerce

LIBRARY AND LABORATORY STAFF



Sh. Devinder Kumar
Assistant Librarian

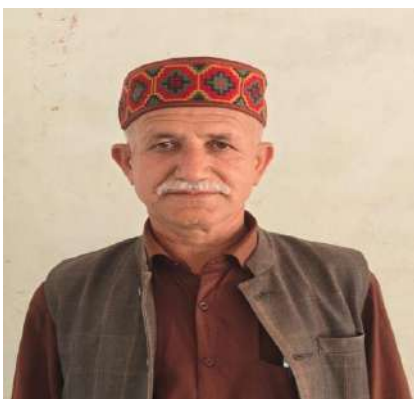

Sh. Surat Singh
Senior Lab Assistant



Sh. Rajender Singh
Lab Attendant



Pradeep Kumar
Lab Attendant

OFFICE STAFF



Sh. Kam Raj
Superintendent G-I



Sh. Kalyan Singh
Sr. Assistant



Sh. Rajender Singh
Junior Office Assistant (IT)

OFFICE SUPPORT STAFF



Sh. Hukmi Ram
Peon



Sh. Khajan Singh
Peon



Sh. Chamel Singh
Peon

Admission cum Counseling and Scrutiny Committees for the Session 2025-26

B.Sc.-I, II & III Ms. Ranjana Chauhan Convener Ms. Sujata Khamn Ms. Reeba Thakur	B.Com. I, II, III Ms. Maneesha Singh Convener Ms. Reena Devi (Music)
B.A. 1st Year Mr. Narender Sharma Convener Mr. Anuj Sharma Mr. Anil Kumar Dr. Sansar Chand	B.A. 2nd Year Mr. Ajay Singh Convener Mr. A.R.Thakur Ms. Vidya Verma
B.A. 3rd Year Mr. Kamlesh Kumar Convener Mr. Ravinder Sharma Mr. R.L. Thakur	
M.A. English Ms. Vidya Verma Convener Mr. R.L. Thakur	M.A. Hindi Mr. A.R. Thakur Convener Ms. Reena Sharma
M.A. History Mr. Ravinder Sharma Convener Mr. Yashpal Sharma	M.A. Political Science Mr. Ajay Singh Convener Mr. Narender Sharma

Annual Committees for the Session 2024-25

College Advisory Committee 1. Principal (Chairman) 2. Mr. Ajay Singh Convener 3. Mr. Narender Sharma 4. Dr. Anuj Sharma 5. Mr. Kamlesh Kumar 6. Ms. Vidya Verma 7. Mr. Ravinder Sharma 8. Mr. A.R. Thakur 9. Ms. Ranjana Chauhan 10. Mr. Anil Kumar 11. Mr. Kamraj Chauhan Supdt.-I	IQAC/NAAC Accreditation Committee 1. Principal (Chairperson) 2- Sh. T.R. Prashar (Ret. Principal) 3. PTA President 4. OSA President 5. Mr. Ajay Singh Co-ordinator 6. Mr. Narender Sharma 7. Dr. Anuj Sharma 8. Mr. Kamlesh Sharma 9. Mr. A.R.Thakur 10. Ms. Vidya Verma 11. Ms. Ranjana Chauhan 12. Dr. Sansar Chand 13. Mr. Kamraj Chauhan (Supdt.-I) 14. Devinder Singh (Asstt. Librarian)
PM USHA Coordination Committee 1. Mr. Narender Sharma Convener 2. Dr. Anuj Sharma 3. Mr. Ravinder Sharma 4. Mr. A.R.Thakur 5. Ms. Ranjana Chauhan	UGC Committee 1. Mr. Ajay Singh Convener 2. Mr. Kamlesh Kumar 3. Dr. Sansar Chand 4. Mr. Yashpal Sharma
NEP Committee 1. Mr. Narender Sharma Co-ordinator 2. Dr. Anuj Sharma 3. Mr. Anil Kumar 4. Ms. Sujata Khamn 5. Ms. Maneesha Singh	College Website Committee/ IT Cell 1. Mr. Narender Sharma Convener 2. Dr. Anuj Sharma 3. Dr. Sansar Chand 4. Mr. Rajender Singh (JOA)
Committee for AISHE 1. Dr. Anuj Sharma Nodal Officer 2. Mr. Kalyan Singh 3. Mr. Rajender Singh	College Online Admission/Fee Committee 1. Dr. Anuj Sharma Convener 2. Dr. Sansar Chand 3. Mr. Rajender Singh (JOA)
College Prospectus Committee 1. Mr. Narender Sharma Convener 2. Dr. Anuj Sharma 3. Ms. Vidya Verma 4. Mr. A.R.Thakur 5. Ms. Reena Sharma	Time Table Committee 1. Mr. Narender Sharma Convener 2. Dr. Anuj Sharma 3. Ms. Ranjana Chauhan 4. Ms. Maneesha Singh

Scholarship /Fee Concession Committee 1. Mr. Ravinder Sharma (INO) 2. Mr. A.R.Thakur 3. Ms. Reena Sharma 4. Mr. Surat Singh (SLA)	Research and Innovation Committee 1. Dr. Anuj Sharma Convener 2. Dr. Sansar Chand 3. Ms. Sujata Khamn 4. Ms. Reeba Thakur 5. Ms. Maneesha Singh
Library Committee 1. Mr. Ajay Singh Convener 2. Mr. Kamlesh Kumar 3. Mr. A.R. Thakur 4. Ms. Ranjana Chauhan 5. Dr. Sansar Chand 6. Mr. R.L. Thakur	Magazine Committee 1. Ms. Reena Sharma (Hindi Section) Chief Editor 2. Ms. Vidya Verma (English Section) 3. Mr. A.R. Thakur (Pahari Section) 4. Ms. Ranjana Chauhan (Science Section) 5. Ms. Maneesha Singh (Planning Section) 6. Mr. Ram Lal (Chronicle Section)
House Examination Committee 1. Dr. Anuj Sharma COE 2. Mr. Ravinder Sharma 3. Mr. Anil Kumar 4. Mr. Surat Singh (SLA) 5. Mr. Rajender Singh (LA) 6. Mr. Pradeep (LA)	Career Counseling and Placement Cell 1. Mr. Kamlesh Kumar Convener 2. Mr. Anil Kumar 3. Mr. R.L. Thakur 4. Dr. Sansar Chand 5. Ms. Sujata Khamn 6. Ms. Maneesha Singh
Building Fund Committee 1. Principal (Chairperson) 2. Panchayat Pradhan 3. President PTA 4. XEN/SDO HPPWD 5. Mr. Ajay Singh (Member Secretary) 6. Mr. Narender Sharma 7. Mr. Kamlesh Kumar 8. Mr. Kamraj Chauhan Supdt.-I 9. Donor	College Land Affairs Committee 1. Mr. Ajay Singh Convener 2. Mr. Narender Sharma 3. Dr. Anuj Sharma 4. Mr. Kamlesh Kumar 5. Mr. A.R. Thakur 6. Ms. Vidya Verma 7. Ms. Ranjana Chauhan 8. Mr. Kamraj Chauhan Supdt.-I
Repair & Maintenance Committee 1. Mr. A.R.Thakur Convener 2. Mr. R.L. Thakur 3. Mr. Kamraj Chauhan Supdt.-I 4. Mr. Kalyan Singh	Campus Beautification/Cleanliness Committee 1. Ms. Reena Sharma Convener 2. Ms. Ranjana Chauhan 3. Ms. Sujata Khamn 4. Mr. Yashpal Sharma 5. Mr. R.L. Thakur

Water and Electricity Affairs Committee 1.Mr. Ravinder Sharma Convener 2. Mr. R.L. Thakur 3. Mr. Kamraj Chauhan 4. Mr. Kalyan Singh 5. Mr. Surat Singh	Bus Pass & Forms Attestation Committee 1. Ms. Vidya Verma Convener 2. Ms. Ranjana Chauhan 3. Ms. Reena Sharma
---	--

Grievances Redressal Cell A) Matters Related to Students' Welfare 1.Principal 2. Mr. Ajay Singh 3. Mr. Kamlesh Kumar 4. Mr. A.R. Thakur 5. Ms. Vidya Verma 6. Mr. Kamraj Chauhan Supdt.-I	B) Matters related to Subject Change, Migration, Roll Back, Re-admission, Registration, Examination& Results. 1. Mr. Narender Sharma Convener 2. Dr. Anuj Sharama 3. Mr. Anil Kumar 4. Dr. Sansar Chand 5. Mr. Rajender Singh (JOA)
Women Empowerment and Committee against Sexual Harassment of women 1. Ms. Vidya Verma Convener 2. Ms. Ranjana Chauhan 3. Ms. Reena Sharma 4. Ms. Reena Devi 5. Ms. Sujata Khamn 6. Ms. Reeba Thakur	Purchase Committee (Common for RUSA and local purchases) 1. Mr. Kamlesh Kumar 2. Mr. Ravinder Sharma 3. Mr. A.R. Thakur 4. Ms. Ranjana Chauhan 5. Mr. Kamraj Chauhan (Supdt.-I)
Discipline cum Anti Ragging Committee 1. Mr. Ajay Singh Convener 2. Mr. Narender Sharma 3. Dr. Anuj Sharma 4. Mr. Kamlesh Kumar 5. Mr. Ravinder Sharma 6. Mr. A.R.Thakur 7. Ms. VidyaVerma 8. Ms. Ranjana Chauhan 9. Mr. Anil Kumar 10. Ms. Reena Devi	Disaster Management Committee 1. Mr. Kamlesh Kumar Convener 2. Mr. Ravinder Sharma 3. Mr. A.R. Thakur 4. Mr. Yashpal Sharma 5. Ms. Sujata Khamn 6. Ms. Maneesha Singh 7. NSS Presidents 8. Rovers & Rangers (Leaders)
Girls' Common Room Committee 1. Ms. Ranjana Chauhan Convener 2. Ms. Reeba Thakur 3. Ms. Sujata Khamn 4. Ms. Maneesha Singh	First Aid Committee 1. Ms. Ranjana Chauhan Convener 2. Mr. Anil Kumar 3. Ms. Reena Devi

Project Monitoring Committee 1. Mr. Ajay Singh Convener 2. Mr. Narender Sharma 3. Mr. Anuj Sharma 4. Mr. Kamlesh Kumar 5. Ms. Vidya Verma 6. Ms. Ranjana Chauhan	Canteen Regulation Committee 1. Mr. Ajay Singh Convener 2. Mr. Narender Sharma 3. Mr. Anuj Sharma 4. Mr. Kamlesh Kumar 5. Ms. Vidya Verma 6. Ms. Ranjana Chauhan 7. Mr. Kalyan Singh
Youth Festival Group-I 1. Mr. Anil Kumar Convener 2. Ms. Ranjana Chauhan 3. Ms. Reena Sharma 4. Mr. Yashpal Sharma 5. Mr. R.L. Thakur	Youth Festival Group-II & III 1. Mr. Ravinder Sharma Convener 2. Ms. Reena Devi 3. Mr. R.L. Thakur 4. Ms. Reeba Thakur
Youth Festival Group –IV 1. Mr. A.R. Thakur 2. Ms. Reena Sharma 3. Mr. R.L. Thakur	Sports Committee 1. Mr. Anil Kumar Convener 2. Mr. R.L. Thakur 3. Dr. Sansar Chand 4. Ms. Reeba Thakur 5. Ms. Maneesha Singh
Annual Report Committee 1. Ms. Vidya Verma 2. Mr. A.R. Thakur 3. Ms. Reena Sharma 4. Mr. R.L. Thakur	Specially Abled Service Cell 1. Mr. Kamlesh Kumar 2. Mr. Ravinder Sharma 3. Ms. Maneesha Singh 4. Ms. Reena Devi
Workshop/Seminar/Conference Organizing Committee 1. Mr. Ajay Singh Convener 2. Mr. Narender Sharma 3. Mr. Kamlesh Kumar 4. Mr. A.R. Thakur 5. Ms. Vidya Verma 6. Ms. Ranjana Chauhan 7. Ms. Reena Sharma 8. Ms. Reeba Thakur	House Allotment Committee 1. Principal (Chairperson) 2. Mr. Ajay Singh 3. Mr. Narender Sharma 4. Ms. Vidya Verma 5. Mr. Anuj Sharma 6. Ms. Reena Sharma 7. Mr. Kalyan Singh
CSCA Advisory Committee 1. Mr. A.R. Thakur Convener 2. Ms. Ranjana Chauhan 3. Ms. Reena Sharma 4. Ms. Reena Devi 5. Mr. R.L. Thakur 5. Mr. Rajender Singh (JOA)	OSA Coordination Committee 1. Ms. Vidya Verma Convener 2. Mr. Ravinder Sharma 3. Ms. Reena Sharma 4. Mr. R.L. Thakur

Central Documentation Cell 1. Mr. Ajay Singh Convener 2. Mr. Narender Sharma 3. Mr. Anuj Sharma 4. Mr. Kamraj Chauhan 5. Mr. Kalyan Singh 6. Mr. Rajender Singh (JOA)	Ambedkar Cell/ Social Justice & Empowerment Cell 1. Ms. Vidya Verma 2. Mr. A.R. Thakur 3. Dr. Sansar Chand 4. Mr. R.L. Thakur 5. Ms. Maneesha Singh
Anti Tobacco & Drug de-addiction Committee 1. Mr. Anil Kumar Convener 2. Mr. Yash Pal 3. Mr. R.L. Thakur 4. Ms. Maneesha Singh 5. Ms. Sujata Khamn	Committee for Quality Initiatives 1. Mr. Ajay Singh Convener 2. Dr. Anuj Sharma 3. Ms. Ranjana Chauhan 4. Dr. Sansar Chand 5. Ms. Sujata Khamn 6. Ms. Reeba Thakur 7. Ms. Maneesha Singh
Committee for Promoting SWAYAM Courses 1. Ms. Vidya Verma Convener 2. Mr. Ravinder Sharma 3. Ms. Reena Sharma 4. Mr. R.L. Thakur	Incubation Center Facilitating Committee 1. Mr. Ajay Singh Convener 2. Mr. Narender Sharma 3. Dr. Anuj Sharma 4. Dr. Sansar Chand

Clubs and Societies

National Service Scheme (NSS) 1. Mr. Yashpal Sharma Programme Officer 2. Ms. Sujata Khamn Programme Officer 3. Mr. Rajender Singh Clerk	Rovers and Rangers 1. Mr. Ajay Singh Rovers 2. Ms. Reeba Thakur Rangers
Red Ribbon Club 1. Ms. Ranjana Chauhan 2. Mr. R.L. Thakur	Electoral Literacy Club 1. Mr. Ajay Singh 2. Mr. Narender Sharma
Road Safety Club 1. Dr. Sansar Chand 2. Mr. R.L. Thakur 3. Ms. Reena Devi	Prehari Club (Say no to Drugs) 1. Mr. Kamlesh Kumar 2. Mr. Yashpal Sharma 3. Ms. Sujata Khamn
Eco. Club/Nature Club 1. Mr. R.L. Thakur 2. Ms. Reeba Thakur 3. Ms. Sujata Khamn	Young Speakers Club 1. Mr. Yashpal Sharma 2. Ms. Reeba Thakur 3. Ms. Sujata Khamn 4. Ms. Maneesha Singh

Science Popularization Club 1. Ms. Ranjana Chauhan 2. Dr. Sansar Chand 3. Ms. Sujata Khamn 4. Ms. Reeba Thakur	Young Trekkers Club 1. Mr. Anil Kumar 2. Mr. R.L. Thakur 3. Dr. Sansar Chand
Yoga and Spiritualism Club 1. Mr. Narender Sharma 2. Mr. Anuj Sharma	Photography Club 1. Mr. Yashpal Sharma 2. Dr. Sansar Chand
Literary Club 1. Ms. Vidya Verma 2. Mr. R.L. Thakur	Sahitya Parishad 1. Mr. A.R. Thakur 2. Ms. Reena Sharma
Art History Club 1. Mr. Ravinder Sharma 2. Mr. Yashpal Sharma	Investment Club 1. Ms. Maneesha Singh 2. Ms. Reena Devi

GENERAL ADMISSION RULES

BA/B.Com/B.Sc. is an under graduate degree course spread over three years. **The number of seats is limited to 80 in each discipline (Subject) purely on the basis of 10+2 merit.**

Admission will be strictly on fulfillment of eligibility conditions.

Any gap in academic career of an applicant must be supported by documentary evidence.
(Attach Self Declaration)

Registration fee of Rs.50/- is to be paid to fill the online admission form.

ONLINE APPLICATION FORM MUST BE FILLED PROPERLY, COMPLETE IN ALL RESPECTS AND SUBMITTED ALONG WITH THE FOLLOWING DOCUMENTS (WHEREVER NECESSARY):

1. Self-attested copy of the character certificate from the institution last attended.
2. Self-attested copy of detailed marks-sheet of the previous examination passed.
3. Self-attested copy of matriculation examination/date of birth certificate.
4. Passport size photographs to be uploaded in the online application form
5. Candidates other than H.P board/H.P University must submit
 - (a): Eligibility certificate from Board/University declaring equivalence .
 - (b): Migration certificate from Board/University from where, they have passed the previous examination.
6. For SC/ST/OBC/IRDP/LIG- certificate signed by class one magistrate/competent authority.

7. All girl candidates have to submit a copy of Bonafide Himachal Certificate to avail the benefit of relaxation from tuition fee as per government notification number E.D.N.-H(8)3(7)1/76 dated 29-6-2001.
8. A student must produce all original certificates at the time of physical verification.
9. Students seeking exemption from tuition fee for disability must attach an attested copy of 40% disability certificate.
10. Any other certificates i.e. Sports/Extra-Curricular activities.
11. **Students with special needs with more than 40% disability will not charged any fees and funds as per Judgment of Hon'ble High Court of HP on dated 04-06-2015, in CWPIlNo. 30 of 2011, titled- "Court on its Own Motion Vs State of HP & Others" and instruction contained in Principal Secretary (Education) to the Govt. of HP vide letter No.EDN-A-Kha(15)7/2019, dated 20-11-2010.**
12. A passport size photograph of the parents / guardians to be uploaded in PTA membership form in online admission application. (Guardian means only blood relation but not a student of this college) Only parents can be the members/office-bearer of PTA executive)
13. The Principal reserves the right to disallow or cancel any admission.
14. Admission will be according to latest HPU roster.
15. Rules for admission are subject to change as per the HPU notifications from time to time.
16. Admission of a student is liable to be cancelled if he/she furnishes incomplete / wrong/false information for in case of concealment of facts. Disciplinary action will also be taken against such candidates.
17. Notwithstanding eligibility for admission, the Principal can refuse admission if the conduct of a student has not been up to the mark during the past years.
Initially, all admissions will be provisional (i.e. Subject to the approval by HP University).

RULES OF MIGRATION

A student can migrate from one college to another after completing 1 year. Inter institution migration (including from one college to another as well as from a college to the ICDEOL and Vice-versa) students will be allowed when no objection is obtained from both the relieving and receiving Institution (signed by their respective principals) to ascertain the subject combinations available in the college.

IMPORTANT NOTE

The directorate of Higher Education, Govt. of Himachal Pradesh issued in its letter no. EDN-H(8)-Misc.-L/(NEP-2020) dated 26.02.2020, regarding implementation of National Education Policy (NEP-2020) across all the colleges in the state. Since then, all the stakeholders across the state were preparing the policy documents for effective implementation of NEP-2020 from the academic session 2025-26. **Therefore, it is pertinent to mention here that all the content mentioned in this prospectus-cum-handbook of information related to admission, syllabus, examination and scheme for CBCS etc. will be governed by the rules and regulation of NEP-2020 in the state (if implemented).**

GENERAL ELIGIBILITY FOR ADMISSION IN UG COURSES

The admission will be on the basis of the marks obtained in 10+2 or equivalent examination.

The reservation of seats will be according to the instructions issued by the H.P. University, Shimla.

The number of seats in each discipline / subject is limited. The candidate will be considered only if he/she is eligible for admission in that course.

The candidate seeking admission in first year should choose his/her Discipline Specific Course (DSC-1) very carefully as he/she will be automatically allotted the SEC's of that discipline for the completion of degree with a specific subject.

Age Limit: For the admission in the UG classes, the applicant must not be more than 23 years (25 years for girls) of age as on 01-07-2025 and must have not born earlier to 01-07-2002. However in case of over-age candidate, the Vice-Chancellor may allow age relaxation up to 6 months. In case of scheduled Caste/Scheduled tribe students, relaxation upto 3 years is allowed as per rules.

BACHELOR OF ARTS (B.A. PASS COURSES)

10+2 examination or an examination equivalent to a Board / University established by law in India with four written subjects (including English) with 33% marks.

Student seeking admission to B.A. 1st year with Mathematics as one of the subject of study, should have either 45% marks in aggregate or 45% marks in Mathematics at +2 level.

BACHELOR OF COMMERCE (B.COM. PASS COURSE)

10+2 examination or an examination equivalent thereto of a Board/University established by law in India with pass in four written subjects (including English) with 45% marks or 40% for those who have passed +2 examination under Commerce Group.

For admission to B.Com. Part-I, the minimum eligibility condition for girl students only shall be 33% marks in +2 examination under 10+2 of any recognized Board.

For arts and science stream, the candidate must have passed Maths / Economics as a compulsory subject at his/her 10+2 stage.

BACHELOR OF SCIENCE (B.SC. PASS COURSE)

10+2 examination or an examination equivalent thereto of a Board/University established by law in India with pass in four written subjects (three Science elective subjects & one English) with 45% marks. Regular candidate shall have to undergo the prescribed course of study in a college affiliated to the H.P. University for period not less than 3 academic years (and not more than 5 academic years), passed the examination prescribed and fulfill such conditions as have been prescribed there for.

For the degree (B.A. / B.Sc. / B.Com.) the student will have to cumulate a minimum of 132 successful credit hours of Course work for a bachelor's degree over a minimum of 3 years and maximum of 5 years from the date of admission. Provided that not more than 3 attempts will be allowed to pass a course.

FEES/ FUNDS/ FINES

1. Every student must pay his/her dues on the dates notified from time to time.
 - a) A student will have to pay dues at the time of admission.
 - b) Failure to pay dues on due date will entail a fine of Re. 1/day.
 - c) In case of non-payment of dues in advance, the name of the student will be struck off from the college rolls at the end of that month.
 - d) Registration fee will not be charged from a student migrating from another college if he/she is already registered with HP University. Other dues will be charged accordingly as per rules.
2. Every student will have to procure No Dues Certificate from the Library, College canteen, Fee Clerk etc. if he/she wants to leave the college.
3. The Principal can expel a student from the College if he/she is found guilty of misconduct/ indiscipline/ ragging.

4. The security deposit will lapse if a student does not apply for refund of security within one year of leaving the college.
5. The fine for absence has to be paid along with dues, while fine imposed otherwise have to be deposited by the date announced in the college office/fee counter.
6. Contribution towards **PTA fund Rs. 600/-** per student (to be paid at the time of admission).
7. No tuition fee is charged from the Bonafide Himachali girls students, subject to production of HP Bonafide Certificate at the time of admission.
8. Students having more than 40% disability are exempted from tuition fee.
9. **Migration Fee: Rs. 500/-.**

DETAIL OF FEE STRUCTURE

Type of Fee	Particular of Fee/ Fund	1 st Year				2 nd Year		3 rd Year	
		Boys		Girls		Boys	Girls	Boys	Girls
		All Category	IRDP/ BPL	All Category	IRDP/ BPL				
Govt. Fee	Admission Fee (Late Admission Fee Rs. 10/day)	25	25	25	25	25	25	25	25
	Tuition Fee (Exempted for Girls of HP Bonafide)	600	600	---	---	600	---	600	---
H.P.U. Fund	University Dev. Fund (at the time of 1 st Admission only)	250	100	250	100	---	---	---	---
	Continuation Fee (For 2 nd & 3 rd Year Students only)	---	---	---	---	10	10	10	10
	University Sports Fee	15	15	15	15	15	15	15	15
	HPU Youth Welfare Fund	15	15	15	15	15	15	15	15
	Holiday Home Fund	02	02	02	02	02	02	02	02
College Annual Charges	Library Security (Refundable) (At the time of 1 st Admission only)	100	100	100	100	---	---	---	---
	House Exam Fee	80	80	80	80	80	80	80	80
	Medical/Health Fund	06	06	06	06	06	06	06	06
	Campus Development Fund	10	10	10	10	10	10	10	10
	Book Replacement Fund	25	25	25	25	25	25	25	25
	Furniture Repair Fund	10	10	10	10	10	10	10	10
	Identity Card	10	10	10	10	10	10	10	10
	Magazine Fund	50	50	50	50	50	50	50	50
	NCC Fund	10	10	10	10	10	10	10	10
	Student Aid Fund	02	02	02	02	02	02	02	02
	Cultural Activities Fund	20	20	20	20	20	20	20	20
	Computer & Internet Facility	20	20	20	20	20	20	20	20
	Youth Red Cross Fund	40	40	40	40	40	40	40	40

College Monthly Charges	Amalgamated Fund @ Rs.25/- PM	300	300	300	300	300	300	300	300
	Building Fund @ Rs.10/- PM	120	120	120	120	120	120	120	120
	Sports Fund @ Rs.20/- PM	240	240	240	240	240	240	240	240
	Rovers & Rangers Fund @ Rs.5/- PM	60	60	60	60	60	60	60	60
Other	PTA Fund**	600	600	600	600	600	600	600	600
Total Fee		2610	2460	2010	1860	2270	1670	2270	1670
Practical Fee	Botany Practical	240	240	240	240	240	240	240	240
	Zoology Practical	240	240	240	240	240	240	240	240
	Chemistry Practical	240	240	240	240	240	240	240	240
	Physics Practical	240	240	240	240	240	240	240	240
	Computer Science Practical	240	240	240	240	240	240	240	240
	Commerce Practical	180	180	180	180	180	180	180	180
	Geography Practical	180	180	180	180	180	180	180	180
	Music Practical	180	180	180	180	180	180	180	180
Absence Fine	Class:Rs1/day, Tutorial Group/ Class:Rs2/day, Practical: Rs. 3/day, House Exam:Rs10/paper								
Re-admission	First Time Rs. 100, SecondTimeRs.200								

*FIR is to be lodged, if Identity Card is lost, Duplicate Identity Card fee is Rs.25/-

Note:1. Fee structure is subject to changes as notified by the University from time to time.

2. Concession in fee is allowed as per the rules applicable.

3. No student will be readmitted for the third time in the session.

LEAVE RULES

1. General leave rules:-

a. A tutor can recommend leave up to 6 days; for longer duration i.e. up to 10 days, a student must get the application signed by the Senior Tutor.

b. Leave during House Examination/ Class Test will be sanctioned only by the Principal on the recommendation of the Senior Tutor.

c. Leave for sickness must be accompanied by a medical certificate.

2. Duty Leave Rules:- Participation by the students in Sports/ Cultural/ Co-Curricular activities, Inter-College/ University Competitions shall be considered as duty leave for the period of respective competition(s). Duty leave, however, shall only be allowed if recommended by the concerned activity In-charge, prior proceeding to the event.

CHANGE OF SUBJECT

The change in one subject (DSC subject) is permissible in the 1st year only that too within 15 days of admission. Student may submit an application for change of subject to the Principal. The change of DSC subject will be allowed subject to availability of seats and subject combination.

ROSTER FOR ADMISSION AND RESERVATION

120 points roster for reservation to various categories shall be followed while determining the merit list for admission in each core subject.

1	21	41ST	61CUL	81CUL	101
2	22	42	62	82	102
3	23	43	63	83	103
4	24	44	64	84	104
5	25	45	65SC	85SC	105
6	26SC	46SC	66HC	86	106SC
7SC	27ST	47	67ST	87	107ST
8	28	48	68	88	108
9	29	49	69	89	109
10	30	50	70	90	110
11	31	51	71	91SC	111
12SC	32	52SC	72SC	92	112
13ST	33SC	53ST	73	93ST	113SC
14	34HC	54	74	94	114
15	35	55	75	95	115
16	36	56	76	96	116
17	37	57	77	97SC	117SP
18SC	38CUL	58	78SC	98CUL	118CUL
19SP	39SC	59SC	79SP	99SP	119SC
20CUL	40SP	60SP	80ST	100HC	120ST

SC-Schedule Caste (15%) = 18 Seats. ST-Schedule Tribe (7.5%) = 9 Seats. SP-Sports Person (5%) = 6Seats. CUL-Cultural (5%) = 6Seats.HC-Handicapped (3%)=3Seats.

One seat over & above is reserved for Single Girl Child (only child of parents, that too a girl). For seeking admission against this seat parents will have to submit an affidavit in support their claim.

CHOICE BASED CREDIT SYSTEM (CBCS)

The Himachal Pradesh University vide letter no. 2-1/2012 H.P.U (Academics) dated 4th June, 2016, has adopted the Choice Based Credit System in all the colleges of Himachal Pradesh. The CBCS provides an opportunity for the students to choose courses from the prescribed courses comprising core, elective / minor or skill based courses. The choice based credit system not only offers opportunities and avenues to learn core subjects but also exploring additional avenues of learning beyond the core subjects for holistic development of an individual.

OUTLINE OF CHOICE BASED CREDIT SYSTEM

Discipline Specific Core (DSC) Course: A course, which should compulsorily be studied by a candidate as a core requirement is termed as a Core course.

Elective Course: Generally a course which can be chosen from a pool of courses and which may be very specific or specialized or advanced or supportive to the discipline/subject of study or which provides an extended scope or which enables an exposure to some other discipline/subject/domain or nurtures the candidate's proficiency/skill is called an Elective Course.

Discipline Specific Elective (DSE) Course: Elective courses may be offered by the main discipline/subject of study is referred to as Discipline Specific Elective. The University/Institute may also offer discipline related Elective courses of interdisciplinary nature (to be offered by main discipline/subject of study).

Generic Elective Course (GEC): An elective course chosen generally from an unrelated discipline/subject, with an intention to seek exposure to other subjects/disciplines is called a Generic Elective Course.

A core course offered in a discipline/subject may be treated as an elective by other discipline/subject and vice versa and such electives may also be referred to as Generic Elective.

Ability Enhancement Compulsory Course (AECC): Environmental Science, English Communication/MIL Communication.

Skill Enhancement Courses (SEC): These courses may be chosen from a pool of courses designed to provide value-based and/or skill-based instruction.

Contact Hours: Each course has 5 lectures and 1 tutorial per week in case of DSC, DSE and GECourses. Each course has 4 lectures and 2 Practical per week in case of SEC courses.

Duration of Study: This is a three year course. The degree will be awarded when a candidate clears all courses within a maximum period of five years from the date of admission to this course.

Note: A candidate failing in either one or two subjects/papers will be given compartment in that subject/paper and will be eligible for promotion to the next class. Two chances (one at supplementary stage and one at the annual exam stage) will be given to clear the compartment. A candidate failing in three or more subjects/papers will be treated as "FAILED" in that year and will be required to repeat the entire year.

COURSE EVALUATION

All Courses (Core and Elective) offered by Department will have an evaluation system that comprises of the following two components:

Continuous Comprehensive Assessment (CCA) accounting for 30% of the final grade that a student gets in a course.

End-of-Year Examination (EYE) accounting for the remaining 70% of the final grade that the student gets in a course.

A student will have to secure a minimum of 35% in both the components i.e. CCA and EYE separately and 40% in aggregate to become eligible to be declared successful in a course.

Classroom Attendance- Each student will have to attend a minimum of 75% attendance Lectures/Tutorials. A student having less than 75% attendance will not be allowed to appear in the End-of-Year Examination (EYE).

CONTINUOUS COMPREHENSIVE ASSESSMENT (CCA): CCA will have the following components:

Component		Marks
Class Attendance		05
Class Test	Upon completion of 40% of syllabus	05
House Test	Upon completion of 75% of syllabus	10
Seminar/Assignment /Tutorials		10
Total		30

Pattern of Question Paper for End-of-Year Examination (EYE):

Section	Part	No. of Question	Nature of Question and Answers	Marks	Syllabus Coverage	Question to be attempted	Maximum Marks
I	A	5	Short Ans. type (25-30 words)	2	Complete	5	10
	B	7	Short essay type (70-75 words)	5	Complete	4	20
II	A	2	Essay type (about 500 words)	10	Unit-I	1	10
	B	2		10	Unit-II	1	10
	C	2		10	Unit-III	1	10
	D	2		10	Unit-IV	1	10
Total Section I + Section II							70

Evaluation of Project Work: 100 marks in which the 70:30 marking ratio shall be as follows: 30 marks for Internal assessment (CCA) and remaining 70 marks (EYE) to be

distributed as 50 marks for Dissertation + 20 marks for Viva Voce. Therefore 30 + (50 + 20) = 100 marks. For students enrolled with ICDEOL there will be no internal assessment and marks secured out of 70 will be rationalized using the multiplier as mentioned above.

SCHEME FOR CBCS IN BA (ANNUAL SYSTEM)

Year	Core Course	AECC (2)	SEC (2)	DSE (4)	GE (2)	Credits
1st Year	DSC-1A	1.ENG/HIN	--	--	--	6X6=36
	DSC-1B					
	DSC-2A	2.EVS				2X4=08
	DSC-2B					
	ENG-1 HIND-1					Total=44
2nd Year	DSC-1C	--	SEC-1	--	--	6X6=36
	DSC-1D		SEC-2			
	DSC-2C					2X4=08
	DSC-2D					
	ENG-2 HIND-2					Total=44
3rd Year	--	--	SEC-3	DSE-1A	GE-1	2X4=08
			SEC-4	DSE-1B	GE-2	4X6=24
				DSE-2A		2X6=12
				DSE-2B		Total=44
Total Credits						132

BACHELOR OF ARTS (B.A. 1ST YEAR) SUBJECT COMBINATIONS

Note: Students can choose any combination in DSC I and DSC II as given bellow. However allotment of subject will depend up on the availability of seats. In such case the subject will be allotted on the basis of merit.

S. No.	DSC-1	DSC-2
1	Economics	Eng, Geo, Math, Pol. Sci, Pub. Ad, Soc.
2	English	Eco, Geo, His, Math, Pol. Sci, Pub. Ad,
3	Geography	Eco, Eng, His, Math, Music, Pol. Sci,
4	Hindi	His, Music, Pol. Sci, Pub. Ad, Soc.
5	History	Eng, Geo, Hin, Music, Pol. Sci, Pub. Ad, Soc.
6	Mathematics	Eco, Eng, Geo, Pol. Sci, Hist
7	Music (Vocal)	Geo, Hin, His, Pol. Sci, Pub. Ad, Soc.
8	Political Science	Eco, Eng, Geo, Hin, His, Math, Soc.
9	Public Administration	Eco, Eng, Hin, His, Math, Music, Soc.
10	Sociology	Eco, Hin, His, Music, Pol. Sci, Pub. Ad

SCHEME FOR CBCS IN B. SC. (ANNUAL SYSTEM)

Year	Core Course	AECC (2)	SEC (2)	DSE (4)	GE (2)	Credits
1st Year	DSC-1A	1.English	--	--	--	6X6=36
	DSC-1B					
	DSC-2A	2.EVS				2X4=08
	DSC-2B					
	DSC-3A					
	DSC-3B					Total=44
2nd Year	DSC-1C	--	SEC-1	--	--	6X6=36
	DSC-1D		SEC-2			
	DSC-2C					2X4=08
	DSC-2D					
	DSC-3C					
	DSC-3D					Total=44
3rd Year	--	--	SEC-3	DSE-1A	--	2X4=08
			SEC-4	DSE-1B		4X6=24
				DSE-2A		2X6=12
				DSE-2B		
				DSE-3A		
				DSE-3B		Total=44
Total Credits						132

BACHELOR OF SCIENCE (B.SC. 1ST YEAR) SUBJECT COMBINATIONS

Sr. No.	DSC-1	DSC-2 and DSC-3
1	Physics	Chemistry, Mathematics
2	Chemistry	Physics, Mathematics
3	Chemistry	Botany, Zoology
4	Mathematics	Physics, Chemistry
5	Botany	Zoology, Chemistry
6	Zoology	Botany, Chemistry

SCHEME FOR CBCS IN B.COM (ANNUAL SYSTEM)

Year	Core Course	AECC (2)	SEC (2)	DSE (4)	GE (2)	Credits
1st Year	DSC 4 Courses ENG-1 HIND-1	1.ENG/HIN 2.EVS	--	--	--	6X6=36 2X4=08 Total=44
2nd Year	DSC 4 Courses ENG-2 HIND-2	--	SEC-1 SEC-2	--	--	6X6=36 2X4=08 Total=44
3rd Year	--	--	SEC-3 SEC-4	DSE 4 Courses	GE-1 GE-2	2X4=08 4X6=24 2X6=12 Total=44
Total Credits						132

Note:

For practical lab based papers:

Core course papers, there shall be 2 classes for theory and 1 practical paper per week per 20 students in the practical lab and one period for tutorial (per group)

DSE papers, there shall be 2 classes for theory, 2 practical periods per week per group of 20 students in the practical lab

SEC papers, there shall be 2 classes for theory, one/two practical periods per week per group in the practical lab

For other core and elective courses, there shall be 3 theory classes. There will be one period for tutorial per group.

Environment Science is compulsory for all students of BA, B.Sc and B.Com. First Year.

NOTE:

GEC should be different from DSC-1 and DSC-II, already opted for. If it is same, students can apply separately for change of GE

TYPES OF COURSES OFFERED FOR B.COM

Class	Name of Course	Course Code	Course Type	Credit
B.Com. 1st Year	1. Financial Accounting	BC 1.1	DSC	6
	2. Business Organization & Management	BC 1.2	DSC	6
	3. Business Law	BC 1.3	DSC	6
	4. Business Statistics and Mathematics	BC 1.4	DSC	6
	5. English-1	ENG 101	Compulsory	6
	6. Prayojanmulak Hindi	HIND 101	Compulsory	6
	7. Bhasha aur Samprekshan OR Writing Skills	HIND 104 ENG 104	AECC	4
	8. Environmental Science	ENVS2AEC C02	AECC	4 (44)
B.Com. 2nd Year	1. Company Law	BC 2.1	DSC	6
	2. Income Tax Law and Practice	BC 2.2	DSC	6
	3. Corporate Accounting	BC 2.4	DSC	6
	4. Cost Accounting	BC 2.5	DSC	6
	5. Computer Applications in Business	BC 2.3	SEC	4
	6. E-Commerce	BC 2.6	SEC	4
	7. English-2	ENG 201	Compulsory	6
	8. Anivarya Hindi “Rachna Punj”	HIND 201	Compulsory	6 (88)
B.Com. 3rd Year	1. Fundamentals of Financial Management	BC 3.1c	DSE	6
	2. Corporate Governance and Auditing	BC 3.2a	DSE	6
	3. Management Accounting	BC 3.5c	DSE	6
	4. Fundamentals of Investment	BC 3.6c	DSE	6
	5. Economy of Himachal Pradesh	ECONA 313	GE	6
	6. Indian Economy	ECONA 314	GE	6
	7. Entrepreneurship	BC 3.3	SEC	4
	8. Personal Selling and Salesmanship	BC 3.7	SEC	4 (132)

TYPES OF COURSES OFFERED BY DEPARTMENT OF ECONOMICS

Class	Name of Course	Course Code	Course Type	Credit
BA 1st Year	1. Principles of Micro Economics-I	ECON 101	DSC	6
	2. Principles of Micro Economics-II	ECON 102	DSC	6
	3. Course from 2 nd subject		DSC	6
	4. Course from 2 nd subject		DSC	6
	5. English-1	ENG 101	Compulsory	6
	6. Prayojanmulak Hindi	HIND 101	Compulsory	6
	7. Bhasha aur Samprekshan OR Writing Skills	HIND 104 ENG 104	AECC	4
	8. Environmental Science	ENVS2AEC C02	AECC	4 (44)
BA 2nd Year	1. Principles of Macroeconomics-I	ECON 201	DSC	6
	2. Principles of Macroeconomics-II	ECON 202	DSC	6
	3. Course from 2 nd subject		DSC	6
	4. Course from 2 nd subject		DSC	6
	5. Economics of Rural Development	ECON 204	SEC	4
	6. Demography	ECON 206	SEC	4
	7. English-2	ENG 201	Compulsory	6
	8. Anivarya Hindi “Rachna Punj”	HIND 201	Compulsory	6 (88)
BA 3rd Year	1. Indian Economy	ECON 301	DSE	6
	2. International Economics	ECON 306	DSE	6
	3. Course from 2 nd subject		DSE	6
	4. Course from 2 nd subject		DSE	6
	5. Economy of Himachal Pradesh	ECON 313	GE*	6
	6. Indian Economy	ECON 314	GE*	6
	7. Public Finance	ECON 310	SEC	4
	8. Money and Banking	ECON 311	SEC	4 (132)

TYPES OF COURSES OFFERED BY DEPARTMENT OF ENGLISH

Class	Name of Course	Course Code	Course Type	Credit
BA 1st Year	1. English Literature-I (Essays, Stories and Poems)	ENG 102	DSC	6
	2. English Literature-II (Poems, Short-Stories and Essays)	ENG 103	DSC	6
	3. Course from 2 nd subject		DSC	6
	4. Course from 2 nd subject		DSC	6
	5. English-1	ENG 101	Compulsory	6
	6. Prayojanmulak Hindi	HIND 101	Compulsory	6
	7. Bhasha aur Samprekshan OR Writing Skills	HIND 104 ENG 104	AECC	4
	8. Environmental Science	ENVS2AEC C02	AECC	4 (44)
BA 2nd Year	1. British Literature (Novel and Play)	ENG 202	DSC	6
	2. Literature Cross Currents	ENG 203	DSC	6
	3. Course from 2 nd subject		DSC	6
	4. Course from 2 nd subject		DSC	6
	5. Creative Writing, Book and Media Reviews	ENG 204	SEC	4
	6. Translation Studies and Principles of Translation	ENG 205	SEC	4
	7. English-2	ENG 201	Compulsory	6
	8. Anivarya Hindi “Rachna Punj”	HIND 201	Compulsory	6 (88)
BA 3rd Year	1. Soft Skills	ENG 303	DSE	6
	2. Academic Writing and Composition	ENG 304	DSE	6
	3. Course from 2 nd subject		DSE	6
	4. Course from 2 nd subject		DSE	6
	5. Contemporary India: Women and Empowerment	ENG 306	GE*	6
	6. Language, Literature and Culture	ENG 305	GE*	6
	7. Technical Writing	ENG 301	SEC	4
	8. Business Communication	ENG 302	SEC	4 (132)

TYPES OF COURSES OFFERED BY DEPARTMENT OF GEOGRAPHY

Class	Name of Course	Course Code	Course Type	Credit
BA 1st Year	1. Physical Geography	GEOGP 101	DSC	6
	2. General Cartography	GEOGP 102	DSC	6
	3. Course from 2 nd subject		DSC	6
	4. Course from 2 nd subject		DSC	6
	5. English-1	ENG 101	Compulsory	6
	6. Prayojanmulak Hindi	HIND 101	Compulsory	6
	7. Bhasha aur Samprekshan OR Writing Skills	HIND 104 ENG 104	AECC	4
	8. Environmental Science	ENVS2AEC C02	AECC	4 (44)
BA 2nd Year	1. Human Geography	GEOGP 201	DSC	6
	2. Environmental Geography	GEOGP 202	DSC	6
	3. Course from 2 nd subject		DSC	6
	4. Course from 2 nd subject		DSC	6
	5. Regional Planning & Development	GEOGP 203	SEC	4
	6. Remote Sensing and GPS	GEOGP 204	SEC	4
	7. English-2	ENG 201	Compulsory	6
	8. Anivarya Hindi “Rachna Punj”	HIND 201	Compulsory	6 (88)
BA 3rd Year	1. Geography of India	GEOGP 303	DSE	6
	2. Disaster Management	GEOGP 304	DSE	6
	3. Course from 2 nd subject		DSE	6
	4. Course from 2 nd subject		DSE	6
	5. Disaster Risk Reduction	GEOGP 305	GE*	6
	6. Sustainability and Development	GEOGP 306	GE*	6
	7. Geographic Information System	GEOGP 301	SEC	4
	8. Field Techniques and Survey based Project Work	GEOGP 302	SEC	4 (132)

TYPES OF COURSES OFFERED BY DEPARTMENT OF HINDI

Class	Name of Course	Course Code	Course Type	Credit
BA 1st Year	1. Hindi Sahitya Ka Itihaas	HIND 102	DSC	6
	2. Madhyakalin Hindi Kavita	HIND 103	DSC	6
	3. Course from 2 nd subject		DSC	6
	4. Course from 2 nd subject		DSC	6
	5. English-1	ENG 101	Compulsory	6
	6. Prayojanmulak Hindi	HIND 101	Compulsory	6
	7. Bhasha aur Samprekshan OR Writing Skills	HIND 104 ENG 104	AECC	4
	8. Environmental Science	ENVS2AEC C02	AECC	4 (44)
BA 2nd Year	1. Adhunik Hindi Kavita	HIND 202	DSC	6
	2. Hindi Gadya Sahitya	HIND 203	DSC	6
	3. Course from 2 nd subject		DSC	6
	4. Course from 2 nd subject		DSC	6
	5. Karyalayee Hindi	HIND 204	SEC	4
	6. Anuvad Vigyan	HIND 206	SEC	4
	7. English-2	ENG 201	Compulsory	6
	8. Anivarya Hindi “Rachna Punj”	HIND 201	Compulsory	6 (88)
BA 3rd Year	1. Lok Sahitya	HIND 305	DSE	6
	2. Chhayavadotar Hindi Kavita	HIND 306	DSE	6
	3. Course from 2 nd subject		DSE	6
	4. Course from 2 nd subject		DSE	6
	5. Adhunik Bhartiya Sahitya	HIND 307	GE*	6
	6. Srijnatmak Lekhan Ke Vividh Kshetra	HIND 308	GE*	6
	7. Rang Alekh Evam Rangmanch	HIND 301	SEC	4
	8. Samachar Sankalan aur Lekhan	HIND 304	SEC	4 (132)

TYPES OF COURSES OFFERED BY DEPARTMENT OF HISTORY

Class	Name of Course	Course Code	Course Type	Credit
BA 1st Year	1. History of India from the Earliest Times up to C.300 CE	HIST 101	DSC	6
	2. History of India C. 300 to 1206	HIST 102	DSC	6
	3. Course from 2 nd subject		DSC	6
	4. Course from 2 nd subject		DSC	6
	5. English-1	ENG 101	Compulsory	6
	6. Prayojanmulak Hindi	HIND 101	Compulsory	6
	7. Bhasha aur Samprekshan OR Writing Skills	HIND 104 ENG 104	AECC	4
	8. Environmental Science	ENVS2AEC C02	AECC	4 (44)
BA 2nd Year	1. History of India 1206 to 1707	HIST 203	DSC	6
	2. History of India 1707 to 1950	HIST 204	DSC	6
	3. Course from 2 nd subject		DSC	6
	4. Course from 2 nd subject		DSC	6
	5. Historical Tourism	HIST 213	SEC	4
	6. An Introduction to Archaeology	HIST 215	SEC	4
	7. English-2	ENG 201	Compulsory	6
	8. Anivarya Hindi “Rachna Punj”	HIND 201	Compulsory	6 (88)
BA 3rd Year	1. Modern & Contemporary World History-I: 1871-1919	HIST 305	DSE	6
	2. Modern & Contemporary World History-II: 1919-1992	HIST 307	DSE	6
	3. Course from 2 nd subject		DSE	6
	4. Course from 2 nd subject		DSE	6
	5. Social-Religious Reform Movements in India (19 th and 20 th Centuries)	HIST 310	GE*	6
	6. History of Himachal Pradesh	HIST 312	GE*	6
	7. Indian History and Culture	HIST 317	SEC	4
	8. Introduction to Indian Art	HIST 319	SEC	4 (132)

TYPES OF COURSES OFFERED BY DEPARTMENT OF MUSIC (VOCAL)

Class	Name of Course	Course Code	Course Type	Credit
BA 1st Year	1. Theory of Indian Music, Basic Principals of Indian Music & Biographics of Musicians, Composers and MusicologistS	MUSA 101	DSC	6
	2. Theory of Indian Music (General) & Biographics of Musicians, Composers and Musicologists	MUSA 103	DSC	6
	3. Course from 2 nd subject		DSC	6
	4. Course from 2 nd subject		DSC	6
	5. English-1	ENG 101	Compulsory	6
	6. Prayojanmulak Hindi	HIND 101	Compulsory	6
	7. Bhasha aur Samprekshan OR Writing Skills	HIND 104 ENG 104	AECC	4
	8. Environmental Science	ENVS2AECC02	AECC	4 (44)
BA 2nd Year	1. Theory of Indian Music, Ancient Granthas & Contributions of Musicologists	MUSA 201	DSC	6
	2. Theory of Indian Music), Medieval Granthas & Contributions of Musicians & Musicologists	MUSA 203	DSC	6
	3. Course from 2 nd subject		DSC	6
	4. Course from 2 nd subject		DSC	6
	5. Value Based & Practical Oriented course for Hindustani Music Prest. & Doc.-I	MUSA 205	SEC	4
	6. Value Based & Practical Oriented course for Hindustani Music Prest. & Doc.-II	MUSA 206	SEC	4
	7. English-2	ENG 201	Compulsory	6
	8. Anivarya Hindi “Rachna Punj”	HIND 201	Compulsory	6 (88)
BA 3rd Year	1. Theory of Indian Music and Study of ancient Granths and Ragas	MUSA 303	DSE	6
	2. Theory of Indian Music and Ghrana Tradition Vocal/Instr.	MUSA 305	DSE	6
	3. Course from 2 nd subject		DSE	6
	4. Course from 2 nd subject		DSE	6
	5. Theory of Indian Music	MUSA 307	GE*	6
	6. Practical, Hindustani Music	MUSA 308	GE*	6
	7. Hindustani Music Prest. & Doc.-III	MUSA 301	SEC	4
	8. Hindustani Music Prest. & Doc.-IV	MUSA 302	SEC	4 (132)

TYPES OF COURSES OFFERED BY DEPARTMENT OF POLITICAL SCIENCE

Class	Name of Course	Course Code	Course Type	Credit
BA 1st Year	1. Introduction to Political Theory	POLS 101	DSC	6
	2. Indian Government and Politics	POLS 102	DSC	6
	3. Course from 2 nd subject		DSC	6
	4. Course from 2 nd subject		DSC	6
	5. English-1	ENG 101	Compulsory	6
	6. Prayojanmulak Hindi	HIND 101	Compulsory	6
	7. Bhasha aur Samprekshan OR Writing Skills	HIND 104 ENG 104	AECC	4
	8. Environmental Science	ENVS2AEC C02	AECC	4 (44)
BA 2nd Year	1. Comparative Government and Politics	POLS 201	DSC	6
	2. Introduction to International Relations	POLS 202	DSC	6
	3. Course from 2 nd subject		DSC	6
	4. Course from 2 nd subject		DSC	6
	5. Legislative Support	POLS 203	SEC	4
	6. Public Opinion and Survey Research	POLS 204	SEC	4
	7. English-2	ENG 201	Compulsory	6
	8. Anivarya Hindi “Rachna Punj”	HIND 201	Compulsory	6 (88)
BA 3rd Year	1. Themes in Comparative Political Theory	POLS 301 (A)	DSE	6
	2. Understanding Globalization	POLS 302 (B)	DSE	6
	3. Course from 2 nd subject		DSE	6
	4. Course from 2 nd subject		DSE	6
	5. Society, Economy & Politics in HP	POLS 305	GE*	6
	6. Human Rights and Gender Environment	POLS 306	GE*	6
	7. Democratic Awareness with Legal Literacy	POLS 303	SEC	4
	8. Conflict and Peace Building	POLS 304	SEC	4 (132)

TYPES OF COURSES OFFERED BY DEPARTMENT OF PUBLIC ADMINISTRATION

Class	Name of Course	Course Code	Course Type	Credit
BA 1st Year	1. Administrative Theory	PUBA 101	DSC	6
	2. Indian Administration	PUBA 102	DSC	6
	3. Course from 2 nd subject		DSC	6
	4. Course from 2 nd subject		DSC	6
	5. English-1	ENG 101	Compulsory	6
	6. Prayojanmulak Hindi	HIND 101	Compulsory	6
	7. Bhasha aur Samprekshan OR Writing Skills	HIND 104 ENG 104	AECC	4
	8. Environmental Science	ENVS2AEC C02	AECC	4 (44)
BA 2nd Year	1. Administrative Thinkers	PUBA 201	DSC	6
	2. Development Administration	PUBA 202	DSC	6
	3. Course from 2 nd subject		DSC	6
	4. Course from 2 nd subject		DSC	6
	5. Computer Applications & Office Management	PUBA 203	SEC	4
	6. Human Resource & Logistic Management	PUBA 204	SEC	4
	7. English-2	ENG 201	Compulsory	6
	8. Anivarya Hindi “Rachna Punj”	HIND 201	Compulsory	6 (88)
BA 3rd Year	1. Local Governance	PUBA 303	DSE	6
	2. Financial Administration	PUBA 306	DSE	6
	3. Course from 2 nd subject		DSE	6
	4. Course from 2 nd subject		DSE	6
	5. Constitutional & Administrative Aspects of Himachal Pradesh	PUBA 307	GE*	6
	6. Disaster Management	PUBA 308	GE*	6
	7. Leadership Styles & Conflict Man.	PUBA 301	SEC	4
	8. Stress & Time Management	PUBA 302	SEC	4 (132)

TYPES OF COURSES OFFERED BY DEPARTMENT OF SOCIOLOGY

Class	Name of Course	Course Code	Course Type	Credit
BA 1st Year	1. Introduction to Sociology	SOCL 101	DSC	6
	2. Society in India	SOCL 102	DSC	6
	3. Course from 2 nd subject		DSC	6
	4. Course from 2 nd subject		DSC	6
	5. English-1	ENG 101	Compulsory	6
	6. Prayojanmulak Hindi	HIND 101	Compulsory	6
	7. Bhasha aur Samprekshan OR Writing Skills	HIND 104 ENG 104	AECC	4
	8. Environmental Science	ENVS2AEC C02	AECC	4 (44)
BA 2nd Year	1. Sociological Theories	SOCL 201	DSC	6
	2. Methods of Sociological Enquiry	SOCL 202	DSC	6
	3. Course from 2 nd subject		DSC	6
	4. Course from 2 nd subject		DSC	6
	5. Techniques of Social Research	SOCL 203	SEC	4
	6. Sociology of Environment	SOCL 204	SEC	4
	7. English-2	ENG 201	Compulsory	6
	8. Anivarya Hindi “Rachna Punj”	HIND 201	Compulsory	6 (88)
BA 3rd Year	1. Marriage, Family & Kinship	SOCL 304	DSE	6
	2. Social Stratification	SOCL 305	DSE	6
	3. Course from 2 nd subject		DSE	6
	4. Course from 2 nd subject		DSE	6
	5. Polity and Society in India	SOCL 307	GE*	6
	6. Economy and Society	SOCL 308	GE*	6
	7. Social Demography	SOCL 301	SEC	4
	8. Theory and Practice of Develop.	SOCL 302	SEC	4 (132)

Note: *Generic Elective Course (GEC) is elective course for an unrelated discipline/subject. The students are required to select any two generic elective courses from unrelated discipline(s)/subject(s) other than their First & Second Elective Courses/Subjects.

TYPES OF COURSES OFFERED BY DEPARTMENT OF MATHEMATICS

Class	Name of Course	Course Code	Course Type	Credit
B.SC 1 st Year	1. Differential Calculus	MATH 101	DSC	6
	2. Differential Equations	MATH 102	DSC	6
B.SC 2 nd Year	1. Real Analyses	MATH 201	DSC	6
	2. Algebra	MATH 202	DSC	6
	3.	MATH 20	SEC	4
	4.	MATH 20	SEC	4
B.SC 3 rd Year	1.	MATH 3	DSE	6
	2.	MATH 3	DSE	6
	3.	MATH 3	SEC	4
	4.	MATH 3	SEC	4
	5.	MATH 3	GE	6
	6.	MATH 3	GE	6

TYPES OF COURSES OFFERED BY DEPARTMENT OF PHYSICS

Class	Name of Course	Course Code	Course Type	Credit
B.SC 1 st Year	1. Mechanics	PHYS 101	DSC	6
	2. Electricity, Magnetism and EMT	PHYS 102	DSC	6
B.SC 2 nd Year	1. Statistical and Thermal Physics	PHYS 201	DSC	6
	2. Wave and Optics	PHYS 202	DSC	6
	3.	PHYS 20	SEC	4
	4.	PHYS 20	SEC	4
B.SC 3 rd Year	1.	PHYS 30	DSE	6
	2.	PHYS 30	DSE	6
	3.	PHYS 30	SEC	4
	4.	PHYS 30	SEC	4

TYPES OF COURSES OFFERED BY DEPARTMENT OF CHEMISTRY

Class	Name of Course	Course Code	Course Type	Credit
B.SC 1 st Year	1. Atomic Structure, Bonding, General Organic Chemistry and Aliphatic Hydrocarbons	CHEM 101	DSC	6
	2. States of Matter, Chemical Kinetics & Functional Organic Chemistry	CHEM 102	DSC	6
B.SC 2 nd Year	1. Solutions, Phase Equilibrium, Conductance, Electrochemistry & Organic Chemistry	CHEM 201	DSC	6
	2. Chemistry of Main Group Elements, Chemical Energetics and Equilibria	CHEM 202	DSC	6
	3. Basic Analytical Chemistry	CHEM 203	SEC	4
	4. Fuel Chemistry & Chemistry of Cosmetics & Perfumes	CHEM 204	SEC	4
B.SC 3 rd Year	1.	CHEM 30	DSE	6
	2.	CHEM 30	DSE	6
	3. Chemical Technology & Society and Business Skills for Chemistry	CHEM 307	SEC	4
	4. Pesticide Chemistry & Pharmaceutical Chemistry	CHEM 308	SEC	4

TYPES OF COURSES OFFERED BY DEPARTMENT OF BOTANY

Class	Name of Course	Course Code	Course Type	Credit
B.SC 1 st Year	1. Biodiversity (Microbes, Algae, Fungi and Archgoniate)	BOTA 101	DSC	6
	2. Plant Ecology and Taxonomy	BOTA 102	DSC	6
B.SC 2 nd Year	1. Plant Anatomy and Embryology	BOTA 201	DSC	6
	2. Plant Physiology and Metabolism	BOTA 202	DSC	6
	3. Biofertilizers	BOTA 203	SEC	4
	4. Gardening and Floriculture	BOTA 204	SEC	4
B.SC 3 rd Year	1.	BOTA 30	DSE	6
	2.	BOTA 30	DSE	6
	3. Medicinal Botany and Ethnobotany	BOTA 306	SEC	4
	4. Mushroom Cultivation	BOTA 307	SEC	4

TYPES OF COURSES OFFERED BY DEPARTMENT OF ZOOLOGY

Class	Name of Course	Course Code	Course Type	Credit
B.SC 1 st Year	1. Animal Diversity	ZOOL 101	DSC	6
	2. Comparative Anatomy and Developmental Biology of Vertebrates	ZOOL 102	DSC	6
B.SC 2 nd Year	1. Physiology and Biochemistry	ZOOL 201	DSC	6
	2. Genetics and Evolutionary Biology	ZOOL 202	DSC	6
	3. Medical Diagnostics	ZOOL 203	SEC	4
	4. Apiculture	ZOOL 204	SEC	4
B.SC 3 rd Year	1.	ZOOL 30	DSE	6
	2.	ZOOL 30	DSE	6
	3. Sericulture	ZOOL 303	SEC	4
	4.	ZOOL 30	SEC	4

POST GRADUATE PROGRAMME

The college is running M.A. classes in English, Hindi, History and Political Science. The admission for these courses will be on the basis of entrance test to be conducted by the H.P. University. The number of seats in MA is 30 in each subject. The merit is decided according to the latest HPU roaster. Upper age limit is 26 years for the boys and 28 years for the girls (29 years in case of SC/ST boys and girls) as on 01-07-2025 and must have not born earlier to 01-07-1999.

The students have to take two **GE** Papers/Courses in Semester 2nd and 4th offered by other Departments under the Scheme of Generic Elective. These Papers will be of 8 credits (4 credits each).

The marks scheme for each paper/course is as follows:

Total Marks: 100 (Theory 80, Internal Assessment 20) Passing Marks: 40 (Theory 32, Internal Assessment 08)

The Internal Assessment for Regular Students will comprise: Attendance 5 marks, Assignment/Presentations 15 marks.

The Internal Assessment for ICDEOL students will comprise 20 marks for Assignments.

No Internal Assessment for Private candidates (Only Theory of 100 marks)

A student shall have to secure at least 40 percent marks in each paper (Theory as well as Internal Assessment) to qualify the examination.

COURSE STRUCTURE FOR POST GRADUATE PROGRAMME

MA ENGLISH				
Semester	Name of Course	Course Code	Course Type	Credit
1st Sem.	1. History of English Literature from Chaucer to 1800	MENG 101	DSC	6
	2. Poetry from Chaucer to Pope	MENG 102	DSC	6
	3. Shakespeare & his Contemporaries	MENG 103	DSC	6
	4. Nineteenth century fiction	MENG 104	DSC	6
2nd Sem.	1. History of English Literature; 19 th and 20 th Centuries	MENG 201	DSC	6
	2. Romantic & Victorian Poetry	MENG 202	DSC	6
	3. Modern Fiction	MENG 203	DSC	6
	4. Growth & Structure of English Language	MENG 204	DSC	6
	5. Advanced Academic Writing	MENG 205	GE	4
3rd Sem.	1. Literacy Criticism from Aristotle to T.S. Eliot	MENG301	DSC	6
	2. Modern British & American Poetry	MENG302	DSC	6
	3. Modern British Drama	MENG303	DSC	6
	4. World Fiction OR African Literature OR Australian Literature OR Canadian Literature	MENG304 to 307	DSE	6
4th Sem.	1. Contemporary Literary Theory	MENG 401	DSC	6
	2. Indian Writing in English	MENG 402	DSC	6
	3. Modern European Drama OR American Drama	MENG 403 MENG 404	DSE	6
	4. Indian Writings in Translation OR Literature and Gender OR Native Writing	MENG 405-407	DSE	6
	5. Contemporary Short Fiction	MENG 408	GE	4

MA HINDI

Semester	Name of Course	Course Code	Course Type	Credit
1st Sem.	1.Madhyakaleen Kavya	MHN 101	DSC	6
	2.Hindi Sahitya ka Itihaas (Adi, Bhakti evm Reeti kaal)	MHN 102	DSC	6
	3.Hindi Natak evmUpanyaas	MHN 103	DSC	6
	4.Bhasha Vigyaan	MHN 104	DSC	6
2nd Sem.	1. Bhakti Reeti Kaavya	MHN201	DSC	6
	2.Hindi Saahitya ka Itihaas (Aadhunik Kaal)	MHN202	DSC	6
	3. Aadhunik Gadhya Saahitya	MHN203	DSC	6
	4.Hindi Bhasha evmDevnagri Leepi	MHN204	DSC	6
	5.Media Lekhan evam Hindi Patrakarita	MHN205	GE	4
3rd Sem.	1.Kaavyashastra evam Saahitya lochan	MHN 301	DSC	6
	2.AnuvaadVigyaan	MHN 302	DSC	6
	3.Chhyavaadi Kaavya	MHN 303	DSC	6
	4. Aadhunik Hindi Kahani OR Aadhunik Hindi Upanyaas OR Aadhunik Hindi Natak OR Aadhunik Hindi Kavita	MHN 304 to 307	DSE	6
4th Sem.	1.Chhayavadottar Kaavya	MHN 401	DSC	6
	2.PaashchatyaSameeksha	MHN 402	DSC	6
	3.Shodh Pravidhi	MHN 403	DSE	6
	4.Lok Sahitya: Sedhantik Vivechan evam Prayogik Aayam	MHN 404	DSE	6
	5.Hindi Sahitya aur Cinema	MHN 405	GE	4

MA HISTORY

Semester	Name of Course	Course Code	Course Type	Credit
1st Sem.	1. History and Historiography	HIST 101	DSC	6
	2. Ancient Societies	HIST 102	DSC	6
	3. Aspects of Medieval Society	HIST 103	DSC	6
	4. Aspects of Society and culture in Early modern Europe, i.e. 1450-1700	HIST 104	DSC	6
2nd Sem.	1. History of early India, (upto i.e AD 1200)	HIST 221	DSC	6
	2. History of Medieval India (13 th to 18 th Centuries)	HIST 222	DSC	6
	3. History of Modern India (1757-1947)	HIST 223	DSC	6
	4. Aspects of Himachal History	HIST 229	GE	4
3rd Sem.	1. History of Ecology & Environment in India	HIST 331	DSC	6
	2. Modern World (c. 1780 to 1950)	HIST 332	DSC	6
	3. A Survey of Himachal History	HIST 333	DSC	6
	4. Contemporary World (1945-2000)	HIST 334	DSC	6
	5. State and Society in Early India OR State & Society in Medieval India OR Constitutional and Adm. History of India (1765-1947)	HIST 335A HIST 335B HIST 335C	DSE	6
	Research and Publication Ethics	HIST 340	AEC	2
4th Sem.	1. Dissertation OR India since Independence (1947-1990s) OR Revolution & Revolutionary Ideas	HIST 441 HIST 442 HIST 443	DSE	6
	2. Religion & Philosophy in Early India OR Mystical Movement in Medieval India OR Social & Cultural Changes in Modern India	HIST 445A HIST 445B HIST 445C	DSE	6
	3. Economic History of Early India (up to c. AD 1200) OR Economic & Social History of Medieval India (1200-1750) OR Economic History of Modern India (1757-1947)	HIST 446A HIST 446B HIST 446C	DSE	6
	4. Indian National Movement (1858-1947)	HIST 449	GE	4

MA POLITICAL SCIENCE

Semester	Name of Course	Course Code	Course Type	Credit
1st Sem.	1. Western Political Thinker	POLS 101	DSC	6
	2. Comparative Politics: Approaches & Processes	POLS 102	DSC	6
	3. Theories & Concepts of International Relations	POLS 103	DSC	6
	4. Indian Politics I: Political Institutions	POLS 104	DSC	6
2nd Sem.	1. Contemporary Debate in Political Theory	POLS 201	DSC	6
	2. Comparative Political Analysis: Concepts & Recent Theories	POLS 202	DSC	6
	3. Indian Politics II: Political Processes	POLS 203	DSC	6
	4. India and the World	POLS 204	GE	6
3rd Sem.	1. Indian Political Thinkers	POLS 301	DSC	6
	2. India's Foreign Policy	POLS 302	DSC	6
	3. Recent Trends in the Politics of South Asia (SAARC Countries)	POLS 303	DSC	6
	4. International Organization OR Research Methods and Research Ethics OR Social Movements in India	POLS 304 POLS 305 POLS 306	DSE	6
	5. Environment and Politics	POLS 307	AEC (Non CGPA)	4
4th Sem.	1. Public International Law	POLS 401	DSC	6
	2. State Politics in India with special reference to HP	POLS 402	DSC	6
	3. Public Policy & Governance in India OR Contemporary Political Thinkers OR Contemporary World Politics OR Dissertation/Project Work	POLS 403 POLS 404 POLS 405 POLS 406	DSE	6
	4. International Political Economy	POLS 407	GE	4

CONDUCT AND DISCIPLINE

The Principal can impose fine, suspension or even rustication on any student who is found indulging in such misconduct as is listed below.

1. Any act of ragging on the campus will be severely dealt with Ragging implies harassment/physical or mental torture to another student by a student or a group of students. Any student found associated in such nefarious activities will be held guilty of gross misconduct. Remember Ragging is a cognizable offence.
2. Anybody found guilty of writing obscene language, words on blackboard, walls or furniture of the college.
3. Aimlessly loitering in the verandas, making noise or attempting to disturb classes.
4. Smoking or consumption of alcohol/drugs etc. in the college campus is strictly prohibited.
5. Bringing unwanted outsider persons to the campus or sitting unnecessary on the passage to the campus.
6. Pasting posters on the walls or notices on the Notice Board without the permission of Principal.
7. Mobile phone should be on switch off mode in classes and on silent mode outside classes/college campus. Indiscipline on campus will not be tolerated.
8. Students who participate in sports or other-curricular activities/educational tours must produce written permission from their parents/guardians.
9. Every student must always carry with him/her duly completed identity card which is issued to him/her at the time of admission. He/she must produce the identity card when- ever demanded by any teacher or the principal.
10. Parents/guardians are requested to remain in touch with the Principal and the concerned teachers regarding the progress of their wards in the college.

SCHOLARSHIP

The different scholarships offered for students are:

1. IRDP scholarship
2. SC/ST scholarships for students with family income less than Rs. 2,50,000
3. Scholarship for OBC students with family income less than Rs. 1,50,000
4. Kalpana Chawla Chhatravriti Yojna (Rs.15,000 p.a) offered to meritorious girl students of HPBOSE
5. Dr. Ambedkar Medhavi Chhatravriti Yojna for EBS students of general category (Incomeless than 1 Lac)

6. Maharishi Balmiki Chattravriti Yojana
7. Post-Merit Scholarship Scheme for Students belonging to Minority Community
8. Post-Matric Scholarship for Students with Disabilities Maulana Azad Scholarship for Girl Students INBA Scholarship for NCC Students INSPIRE Scholarship-for Science students

COLLEGE LIBRARY & TUTORIAL GROUPS

The college has spacious library, where students can study newspapers and books etc. in their free time.

Library Rules:

1. A student must bring his/her library card to get the books issued in his/her name.
2. Only two books are issued to a student at a time for a period of 14 days.
3. Reference Books/ Dictionaries/ Newspapers/ Periodicals will not be issued.
4. If the issued books are not returned by due date, fine at the rate of Rs.1 per book per day will be charged.
5. In case of loss or damage of any issued book, it will either be replaced or its payment of the present cost will be accepted only with the permission of Principal.

LIBRARY CARD

Library Card is an important document, a student must carry every day. In case of loss of Card, an application to the Principal along with **payment of Rs 50/-duplicate library-Card** will be issued. Library Card should be collected from the Librarian as per schedule notified by the librarian.

CO-CURRICULAR AND EXTRA-CURRICULAR ACTIVITIES

Education is a very broad term and goes beyond training of one's mind for acquiring textual knowledge. It is associated with other activities in order to bring about multi-dimensional development of the overall personality of a man. The college provides such opportunities to our students through many co-curricular and other activities that help them to develop a sound body and mind. Our college has many societies like Science Society, Social Science Society, Red Ribbon Club and Eco Club etc. Students are encouraged to join these societies as per their interest. Students can approach the in-charges of these societies for enrolment and participation in various activities conducted by them.

NATIONAL SERVICE SCHEME (NSS)

The College runs NSS program to inculcate the quality of leadership, social service and discipline, among the youth. The student who attend 240 hrs of social service and attend one special camp for 7 days, are given a special benefit of 2% marks at the time of admission to H.P. University Courses.

ROVERS AND RANGERS

The college runs Rovers & Rangers, aims to contribute to the development of the young people in achieving their full physical, intellectual, social and spiritual potentials as individuals.

ECO CLUB

The Eco Club of the college works with an aim to spread awareness regarding the environment among the students. Tree plantation drives, awareness activities such as rallies, educational trips, quiz and poster making competitions, etc. are organized to sensitize the students towards environment related issues.

RED RIBBON CLUB

With the aim of spreading awareness about HIV and AIDS among students, the Government of India initiated the formation of Red Ribbon Clubs in schools and colleges. The primary objective of the club is to create awareness and to induce the spirit among youth to help and support and support people living with HIV/AIDS thereby reducing stigma and discrimination. The objective is to motivate youth and build their capacity as peer educators and agents of change. The club also promotes voluntary blood donation among youth.

COLLEGE MAGAZINE

The college publishes its own magazine “Chandrika” to unleash the creative potential of its students. Every section of the magazine is edited by a staff member and assisted by student editor.

CAREER GUIDANCE AND PLACEMENT CELL

The Career Guidance and Placement Cell guide the students for various career and job oriented opportunities. The Cell also arranges campus interviews of various multinational companies and organizes special lectures on Personality Development.

COLLEGE STUDENTS CENTRAL ASSOCIATION (CSCA)

The members of CSCA are elected as per the rules and regulation of H.P. University every year. The CSCA plays a pivotal role in organizing various, academic and co-curricular activities. Every year CSCA Cultural Meet is organized.

WOMEN GRIEVANCES & REDRESSAL CELL

This cell is especially established to take care of women grievances and their redressal. The students will have the right to make an appeal against any component of evaluation. Such appeal has to be made to the Principal of the College on a prescribed form and should clearly state in writing the reason(s) for the complaint / appeal. The appeal will be placed before the Grievance Redressal Committee (GRC), chaired by College Principal.

PARENT TEACHER'S ASSOCIATION (PTA)

There is a Parent Teacher's Association which plans and undertakes developmental works in the college. The PTA is run by the Executive Committee which is empowered to take all the decisions. During the previous session 2023-24, PTA played a significant role in the smooth functioning of the college.

IQAC CELL

The college had established IQAC cell for the Quality Assurance & Improvement in Teaching-Learning process. The IQAC through its proactive initiatives identifies the key strategic areas of focus through the development and monitoring the parameters for excellence in quality. The IQAC aims to engage student representatives in its constitution to facilitate direct inclusion of the student community in the broad policy framework of the college.

YOGA, HEALTH AND FITNESS CLUB

The college has a Yoga, Health and Fitness Club to promote the importance of a healthy lifestyle among the students and faculty of the college. Regular activities such as yoga practice sessions, meditation sessions, and athletic activities are organized by the club to encourage an active lifestyle and to help students with stress and anxiety issues.

ANTI-RAGGING/ INDISCIPLINE RULES

In order to have zero tolerance and its total elimination from the educational institutions, Hon'ble Supreme Court of India vide its orders dated 4th May, 2001; 16th May, 2007 and 11th Feb. 2009 has directed as under:

1. Ragging is banned in the institution.
2. Anyone indulging in ragging is liable to be punished appropriately. Punishment shall be exemplary and justifiably harsh.
3. Punishment for ragging includes:
 - a. Imprisonment, fine or both.
 - b. Expulsion from the institution, suspension from the institution or class for a limited period or fine with a public apology.
 - c. Withholding scholarship or other benefits.
 - d. Debarring from representation in events.
 - e. Withholding of results.
 - f. Suspension or expulsion from hostel or mess and the like.
4. If the individual committing or abetting ragging is not identified, collective punishment shall be resorted.
5. Character/migration certificate(s) issued by the institution shall have an entry apart from that of general conduct and behaviour to the effect whether the student had participated in ragging and in particular was punished for ragging.
6. In case the applicant for admission is found to have indulged in ragging/indiscipline in the past or if it is noticed later that he/she has indulged in ragging, his/her admission may be refused or he/she shall be expelled from the institution forthwith.

Note: In case of any emergency, the student(s) may contact any member of the Anti- Ragging cum Discipline Committee.

Anti Ragging Help lines:

National Helpline Toll Free No.: 1800-180-5522 State: 0177-2625400, 2625819

e-mail: helping@antiragging.net, cm-hp@nic.in

EVACUATION PLAN OF GOVT. COLLEGE SHILLAI, DISTT SIRMOUR HP

EVACUATION PLAN

Govt. College Shillai Guide Map

OPEN SPACE



N

OPEN SPACE

OPEN SPACE

OPEN SPACE

OPEN SPACE

OPEN SPACE

OPEN SPACE

OPEN SPACE

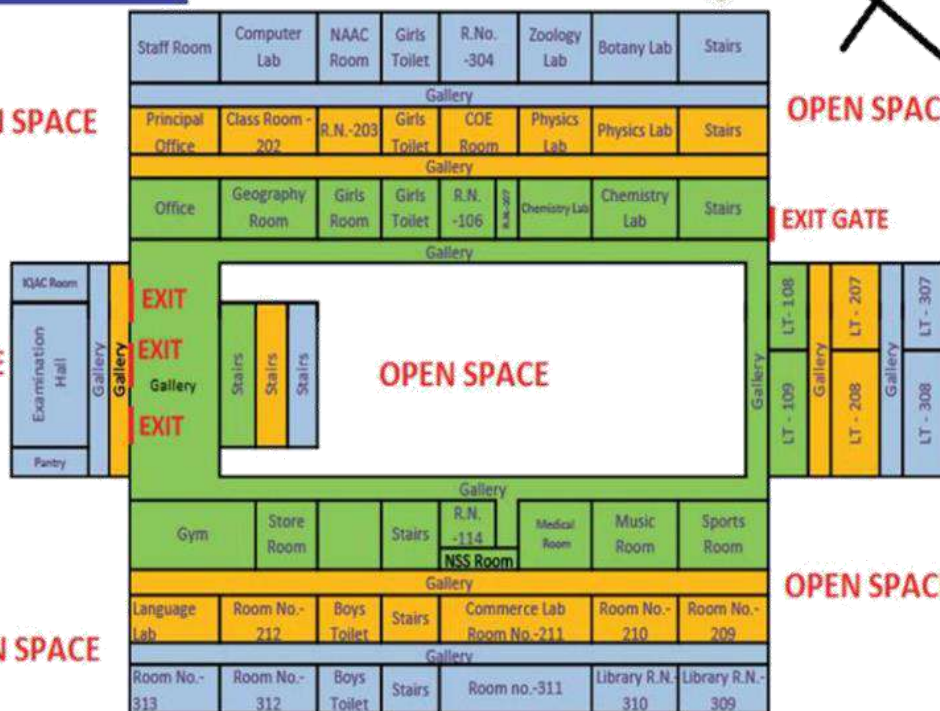

- Ground Floor
- First Floor
- Second Floor
- Gate

Map not to scale

Map-7

EVACUATION PLAN

